

CHOOSE YOUR CABINET STYLE
MEASURE THE KITCHEN SPACE
PLAN YOUR LAYOUT

GUIDE

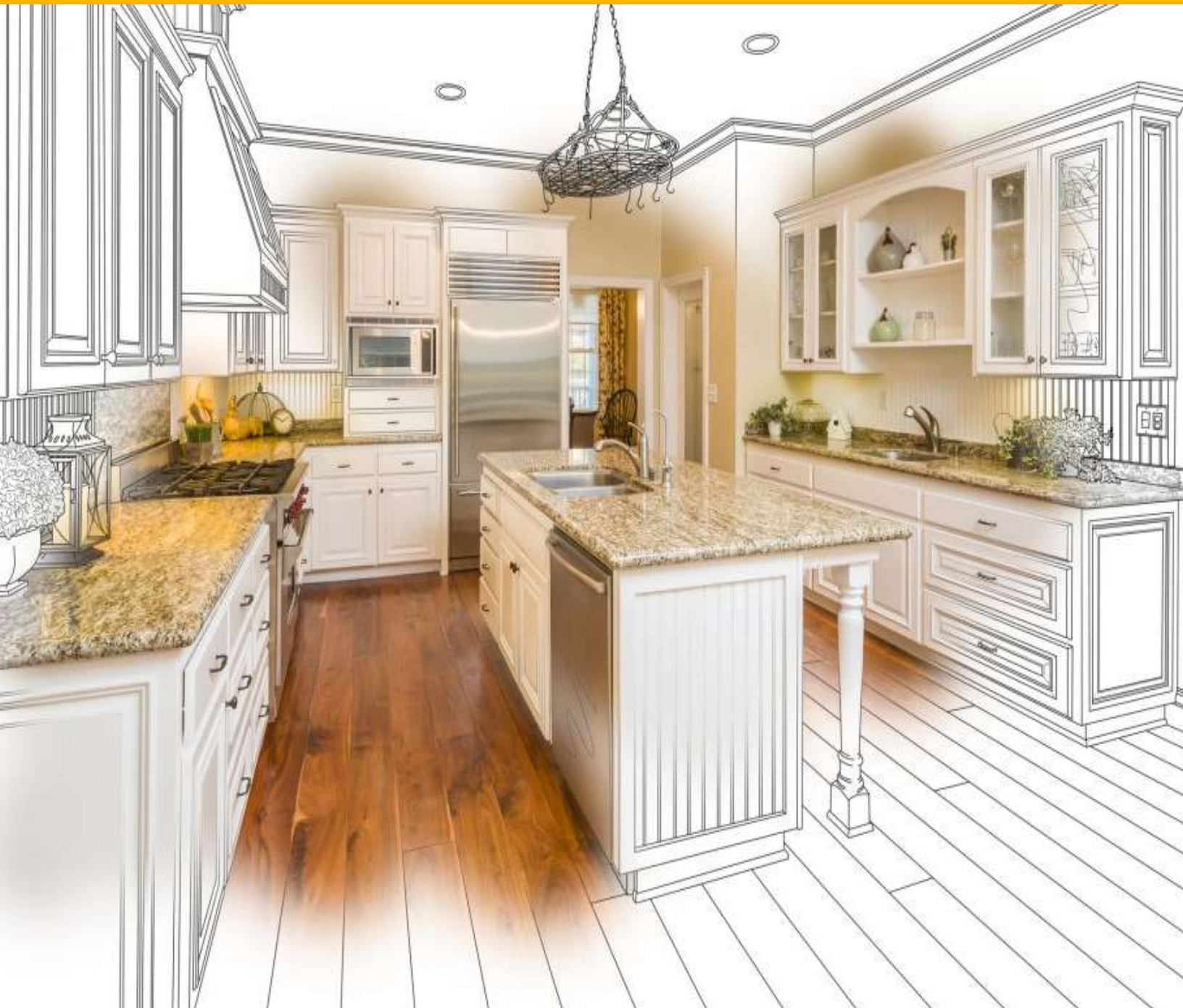

CHOOSE YOUR CABINET STYLE Full Overlay



SW



SG



SB



JG



SE



CS



PW



CW



AW



AG



YC

PRODUCT LIST

Cabinet sizes shown are in stock and available for immediate purchase, but are not a complete representation of all cabinets. Please see sales associate for availability of cabinets not shown.

wall

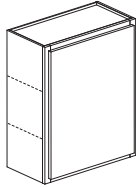

Depth: 12"

Wall Cabinet, Single Door

W0930, W1230, W1530, W1830, W2130

W0936, W1236, W1536, W1836, W2136

W0942, W1242, W1542, W1842, W2142

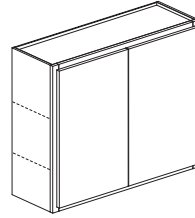

Depth: 12"

Wall Cabinet, Split Doors

W2430, W2730, W3030 W3330, W3630, W3930

W2436, W2736, W3036 W3336, W3636, W3936

W2436, W2736, W3036 W3336, W3636, W3936

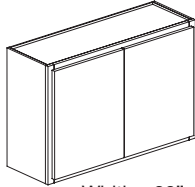

Width: 30"
Depth: 12"

Wall Cabinet, Split Doors

W3012 /W3015 / W3018 W3021 /W3024

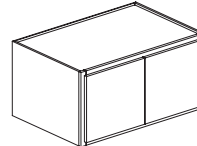

Width: 36"
Depth: 24"

Wall Refrigerator Cabinet, Split Doors

W361224 / W361524 / W361824 W362124 / W362424

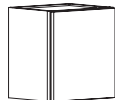

Depth: 12"

Stackable Wall Cabinet Single Doors

W1518, W1818 (Modified) W2118

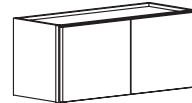

Depth: 12"

Stackable Wall Cabinet Split Doors

W2418 /W2718 (W3018/ W3318/ W3618)

wall corner

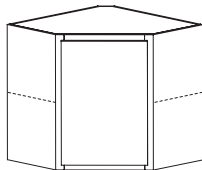

Wall Corner Angle Cabinet, Single Door

DCW2430/ DCW2436/ DCW2442

Width: 24"
Height: 30"/ 36"/ 42"
Depth: 12"

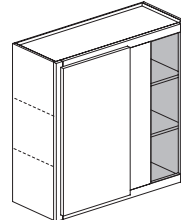

Wall Blind Corner Cabinet, Single Door

WBC2730/ WBC2736/ WBC2742

Width: 24"
Height: 30"/ 36"/ 42"
Depth: 12"

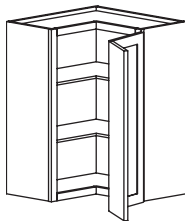

Wall 90 Degree Corner Cabinet

ERC2436/ERC2436/ERC2442

Width: 36"
Height: 30"/ 36"/ 42"
Depth: 24"

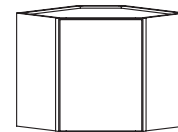

Stackable Wall Corner Angle Cabinet, Single Door

DCW2418

Width: 24"
Height: 18"
Depth: 12"

wall spl

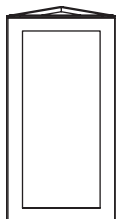

Wall Corner Angle



Wall End Shelf

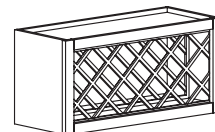

Wine Rack

PRODUCT LIST

Cabinet sizes shown are in stock and available for immediate purchase, but are not a complete representation of all cabinets. Please see sales associate for availability of cabinets not shown.

wall spl

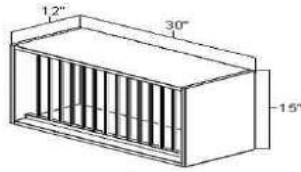
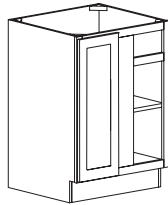

Plate Rack



Glass holder

Base corner



Base Blind Corner Cabinet, Full Height Door
BBC36

Width: 27"
Height: 34 1/2"
Depth: 24"

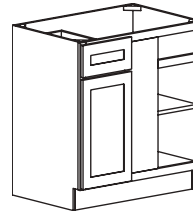

Base Blind Corner Cabinet
BBC39 / BBC42

Width: 36" / 39"
Height: 34 1/2"
Depth: 24"

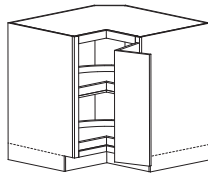

Base Full Height Corner Cabinet
BHFC36, BHFC36LS

Width: 36"
Height: 34 1/2"
Depth: 24"

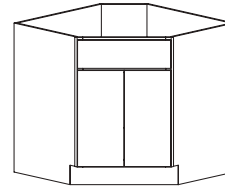

Corner Sink Base Cabinet
DCSB42

Width: 42"
Height: 34 1/2"
Depth: 24"

base

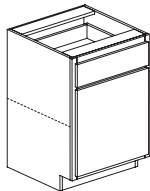

Base Cabinet Single Door
B12, B15, B18, B21

Width: 9"/12"/15"/18"/21"
Height: 34 1/2"
Depth: 24"

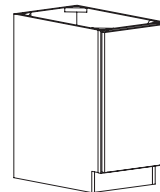

Full Height Door Base Cabinet
BT9, B12, B15, B18, B21, B24
B27, B30, B33, B36, B39

Width: 9" - 42"
Height: 34 1/2"
Depth: 24"

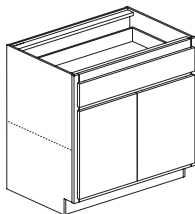

Base Cabinet Split Doors
B24, B27, B30, B33, B36, B39, B42

Width: 24"/27"/30"/33"/36"/39"/42"
Height: 34 1/2"
Depth: 24"

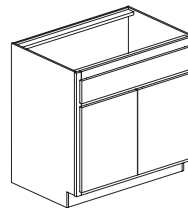

Base Sink Cabinet Split Doors
SB30, SB33, SB36

Width: 30" / 33" / 36"
Height: 34 1/2"
Depth: 24"

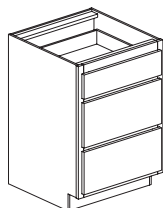

Base 3-Drawer Cabinet

3DB12, 3DB15, 3DB18, 3DB21
3DB24, 3DB27, 3DB30, 3DB33, 3DB36
Width: 12"/15"/18"/21"/24"/27"/30"/33"/36"
Height: 34 1/2"
Depth: 24"

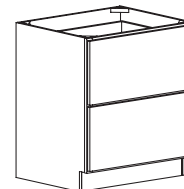

Base 2-Drawer Cabinet

2DB30, 2DB33, 2DB36

Width: 30" / 33" / 36"
Height: 34 1/2"
Depth: 24"

PRODUCT LIST

Cabinet sizes shown are in stock and available for immediate purchase, but are not a complete representation of all cabinets. Please see sales associate for availability of cabinets not shown.

tall

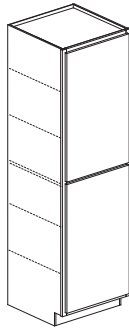

Pantry Cabinet, Single Doors

U188424/ U189024/ U189624

Width: 24"
Height: 84"/ 90"/ 96"
Depth: 24"

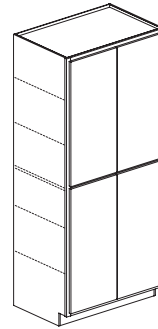

Pantry Cabinet, Split Doors

U248424/ U249024/ U249624
U308424/ U309024/ U309624

Width: 24/ 30"
Height: 84"/ 90"/ 96"
Depth: 24"

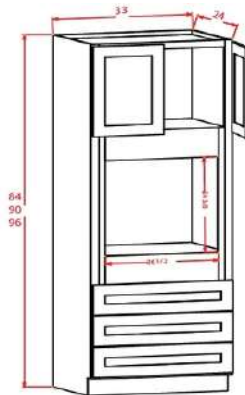

OVEN Cabinet Split Doors

U338424/ U339024/ U339624

Width: 33"
Height: 84"/ 90"/ 96"
Depth: 24"

vanity

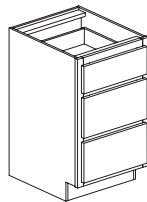

Vanity 3-Drawer Cabinet

3VDB12/ 3VDB15 / 3VDB18
3VDB21/ 3VDB24 / 3VDB27

Width: 12", 15", 18", 21", 24", 27"
Height: 34 1/2"
Depth: 21"

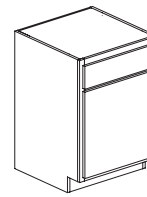

Vanity Sink Cabinet, Single Door

VS18/ VS21

Width: 18" / 21"
Height: 34 1/2"
Depth: 21"

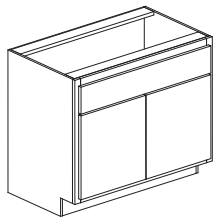

Vanity Sink Cabinet, Split Doors

VS24/ VS27/ VS30/ VS33/ VS36

Width: 24", 27", 30", 33", 36"
Height: 34 1/2"
Depth: 21"

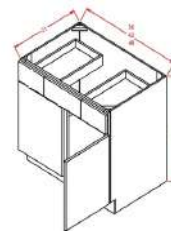

Vanity Sink Cabinet With Drawers

VSD36/ VSD42/ VSD48

Width: 24", 27", 30", 33", 36"
Height: 34 1/2"
Depth: 21"

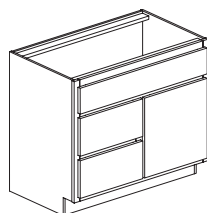

Vanity Sink Combo Cabinet
V3021DL/ V3621DL

Width: 30" / 36"
Height: 34 1/2"
Depth: 21"

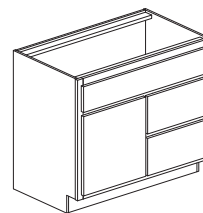

Vanity Sink Combo Cabinet
V3021DR/ V3621DR

Width: 30" / 36"
Height: 34 1/2"
Depth: 21"

PRODUCT LIST

Cabinet sizes shown are in stock and available for immediate purchase, but are not a complete representation of all cabinets. Please see sales associate for availability of cabinets not shown.

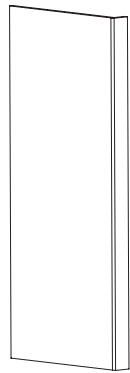

Plain Refrigerator End Panel

REP2496

Width: 1 1/2"
Height: 96"
Depth: 24"

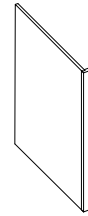

Plain Dishwasher End Panel

DWR3

Width: 3"
Height: 34 1/2"
Depth: 24"

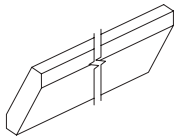

ACM8- 2 1/2"

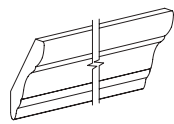

CM8- 2 1/2"

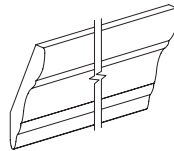

DCM- 3 1/2"

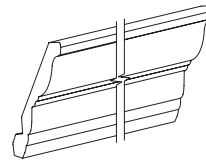

ICM- 4"

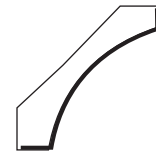

COV- 5"

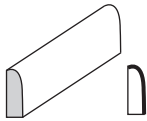

SCR

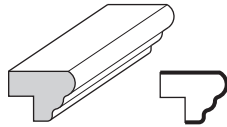

LRM

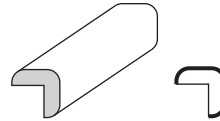

OCM

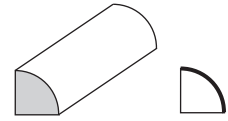

SHM

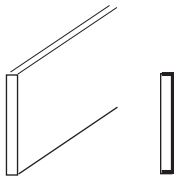

TKC

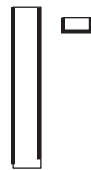

F342 / BF336



F642



F396

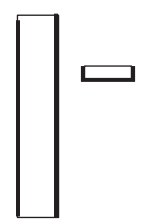

F696

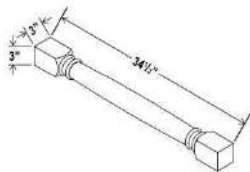

CLDL

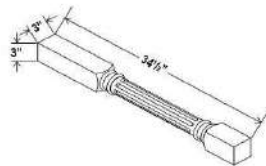

FLDL



VA48

.....Much more items than listed, please check with us!

MEASURE THE KITCHEN SPACE

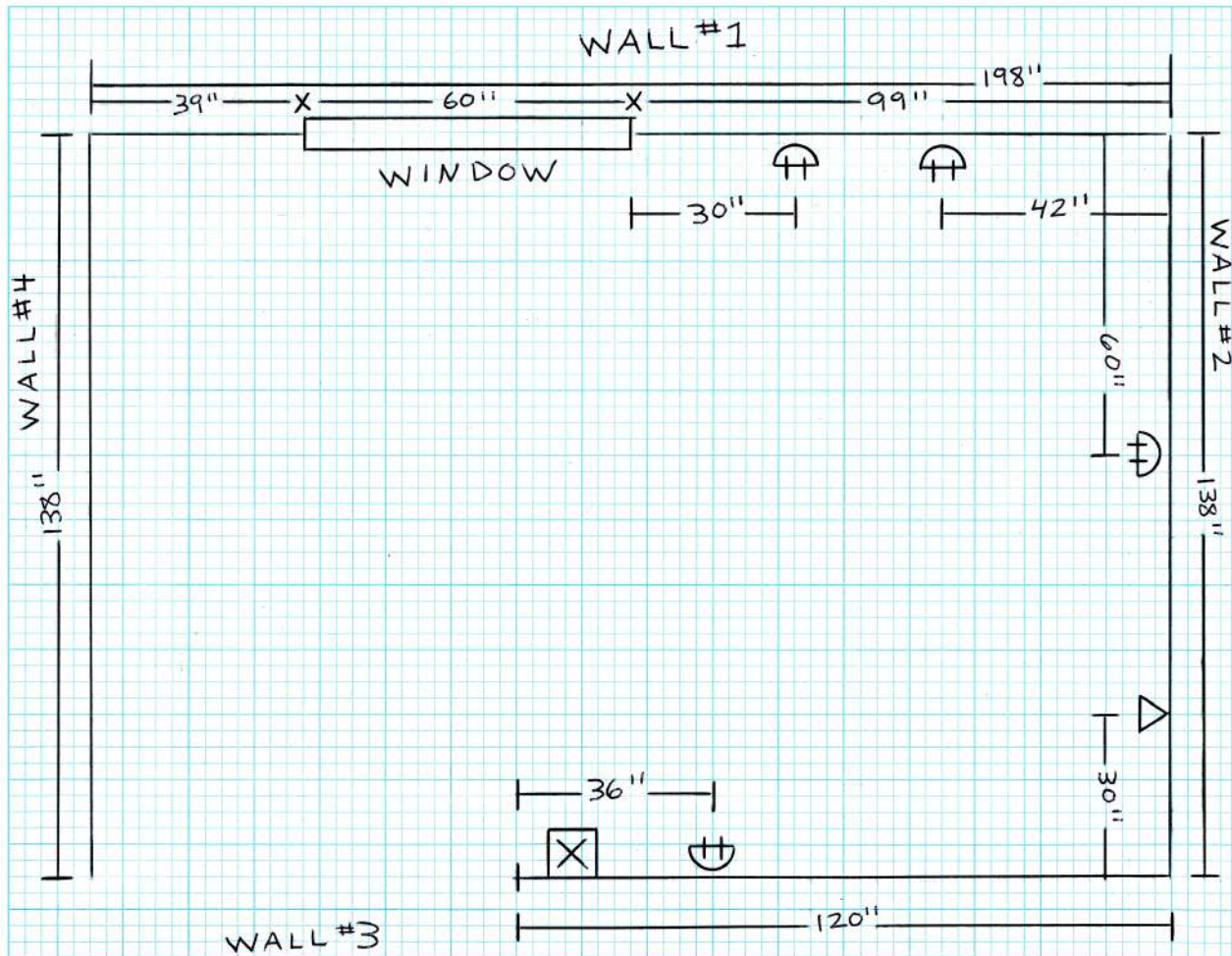

It's important to take your time and make sure your measurements are correct as this will form the foundation of all your planning. To get started, you'll need a tape measure, pencil and grid paper.

1. Start from the left corner of the wall and head in a clockwise direction. Measure from one edge of the wall to the other, skipping over any windows, fixtures and appliances. Label each wall "Wall 1", "Wall 2", etc. and record the dimensions in inches.
2. Once the wall measurements have been recorded, measure all windows and doors, from one outside trim edge to the other outside trim edge and record your measurements on the floor plan.
3. Next, indicate vents, pipes or other obstructions that cannot be moved. Then, record all appliances power sources, water supply, electrical outlets and light switches. Mark the location and center point of all your permanent fixtures.
4. Write down vertical measurements, from floor to the windowsill, from windowsill to the top of the window, and from the top of the window to the ceiling. If you have a dropped ceiling or bulk heads, make sure to include those measurements as well.

Appliance Chart

	width	height	depth
Fridge			
Range			
Dishwasher			
Sink			
Microwave			

PLAN YOUR LAYOUT

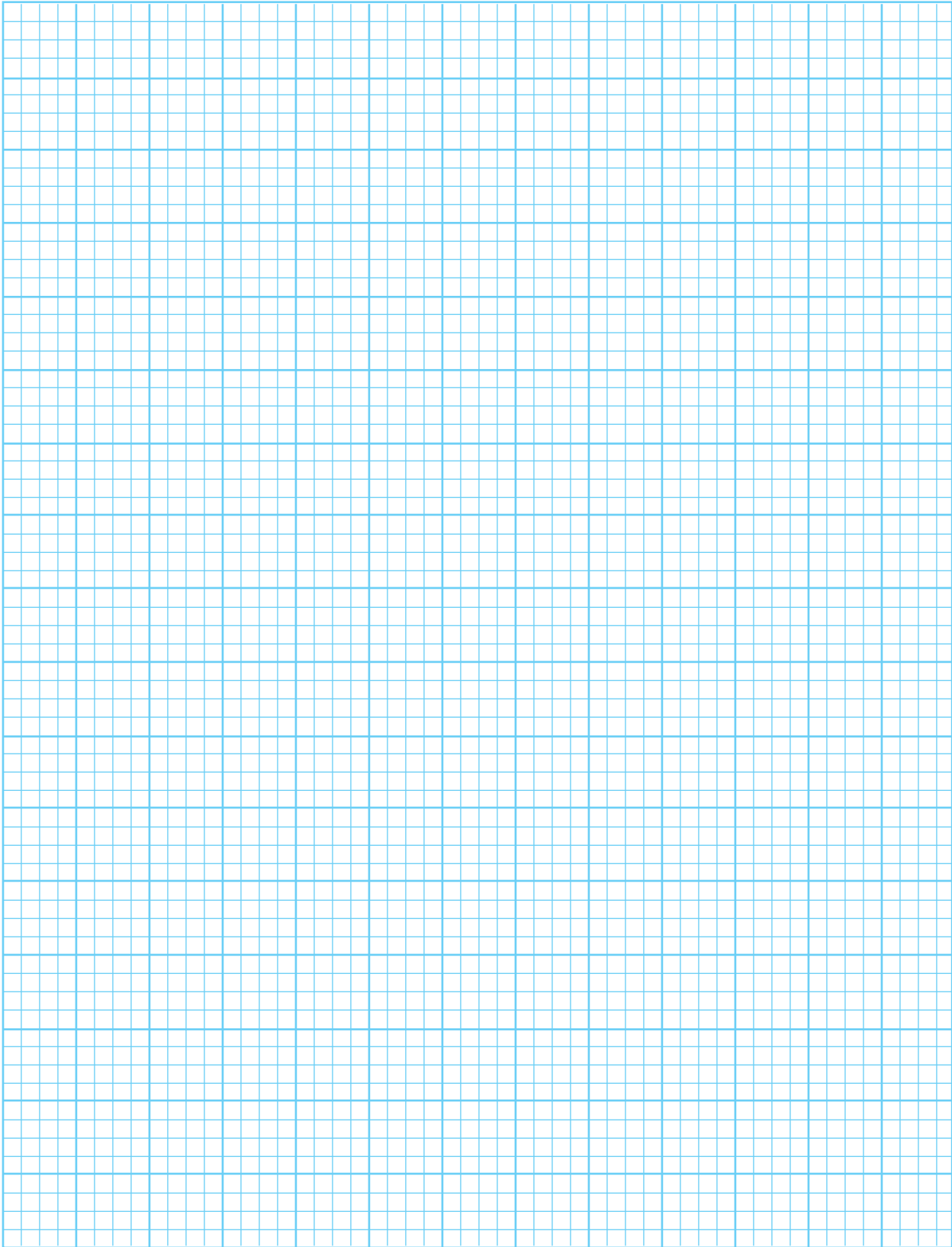

1 square = 3"